

In the narrowest part of this L-shaped bathroom, tiling finishes halfway up the walls, giving it a greater sense of space.

MODERN CLASSIC

Hard surfaces and vintage-style fittings produce a look that's elegant yet edgy.



A cast-iron bath with claw-feet was requested by the client primarily for adult relaxation, while the laboratory-style sink (below right) was chosen to accommodate the needs of their two growing boys.

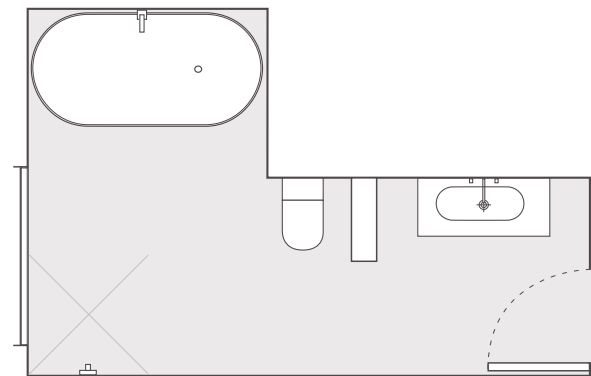

KEY DESIGN FEATURES A shower wet area, a private bathing zone, a large cantilevered basin, and a low wall that hides the toilet from view.

FACT FILE

DESIGNER JUSTINE HUGH-JONES. **BASIN** PARISI 'ACQUAGRANDE' FROM REECE. **BASIN TAPWARE** DORF 'KEMI CROSS' FROM REECE. **BATH** RENAISSANCE 'BAROQUE' FROM REECE. **SHOWERHEAD** HANSGRÖHE FROM THE BATH HOUSE. **BATH & SHOWER TAPWARE** DORF 'MOTIF CROSS' FROM REECE. **LIGHTING** STUDIO ITALIA CHANDELIER FROM EXHIBIT INTERIORS. **TILES** ACADEMY TILES. **FLOOR** POLISHED CONCRETE BY BUILDER PAT STEPHENSON. **PAINT** DULUX VIVID WHITE. **MIRROR** CUSTOM-MADE FROM CHUCK & BOB. **STOOL** TOLIX FROM THONET. For stockists, see Address Book.

Q&A

INTERIOR DESIGNER JUSTINE HUGH-JONES

What was the brief from the client? They wanted to renovate their existing main bathroom; the specific brief was to design a space that, while catering to the needs of two growing boys, would still be sophisticated enough to meet the needs of the adult owners and their guests. A bath to relax in, a shower wet area and concealed storage were all wish-list items, as was a sink large enough for two boys to share. **Describe the design challenges and resolutions.** The L-shaped room was very awkward in configuration and its redesign called for a cantilevered trough-shaped sink to create a feeling of space in the narrowest area. A full-sized freestanding bath was positioned around the corner to offer the bather privacy. The open space of the shower zone allowed the room to incorporate a few glamorous fixtures, such as the black glass chandelier, the elegant sophistication of which is perfectly matched by the large bespoke French-style sectioned-glass mirror that hangs above the basin. **Describe the storage solutions.** A low wall for privacy was built, which solved the issue of hiding the toilet from hallway view, and created concealed storage – a pull-out storage drawer is located within the wall and contains enough space for toiletries. Power outlets were also incorporated into one side of the wall, so even the boys' electric toothbrushes could be kept out of sight. **Explain the choice of new materials and fittings.** My client disliked floor tiles and grout lines and loved the industrial look of polished concrete, which offered the perfect design contrast to the small hexagon tiles chosen for the walls. We decided to bypass contemporary bathroom design convention and only take tiles halfway up the walls because of the awkward shape of the room and to create a sense of space. A cast-iron bath was chosen for its vintage good looks and its black claw-feet, and because it fitted in well with the room's overall colour palette of grey, white and black. The large laboratory-style sink features a practical-sized ledge, on which toiletries can easily be placed when in use. Lastly, we replaced the original clear glass window with opaque glass to give the bather greater privacy from the neighbouring property. It was a simple but effective renovating trick.

